







FREMONT TOWNSHIP
 TUSCOLA COUNTY, MICHIGAN
 FUTURE LAND USE RECOMMENDATIONS
 LAND USE PLAN MAP

KEY

-  AGRICULTURE AND RURAL RESIDENTIAL
-  LOW-DENSITY RESIDENTIAL
-  MEDIUM-DENSITY RESIDENTIAL
-  HIGHWAY COMMERCIAL
-  LOCAL BUSINESS
-  LIGHT INDUSTRIAL

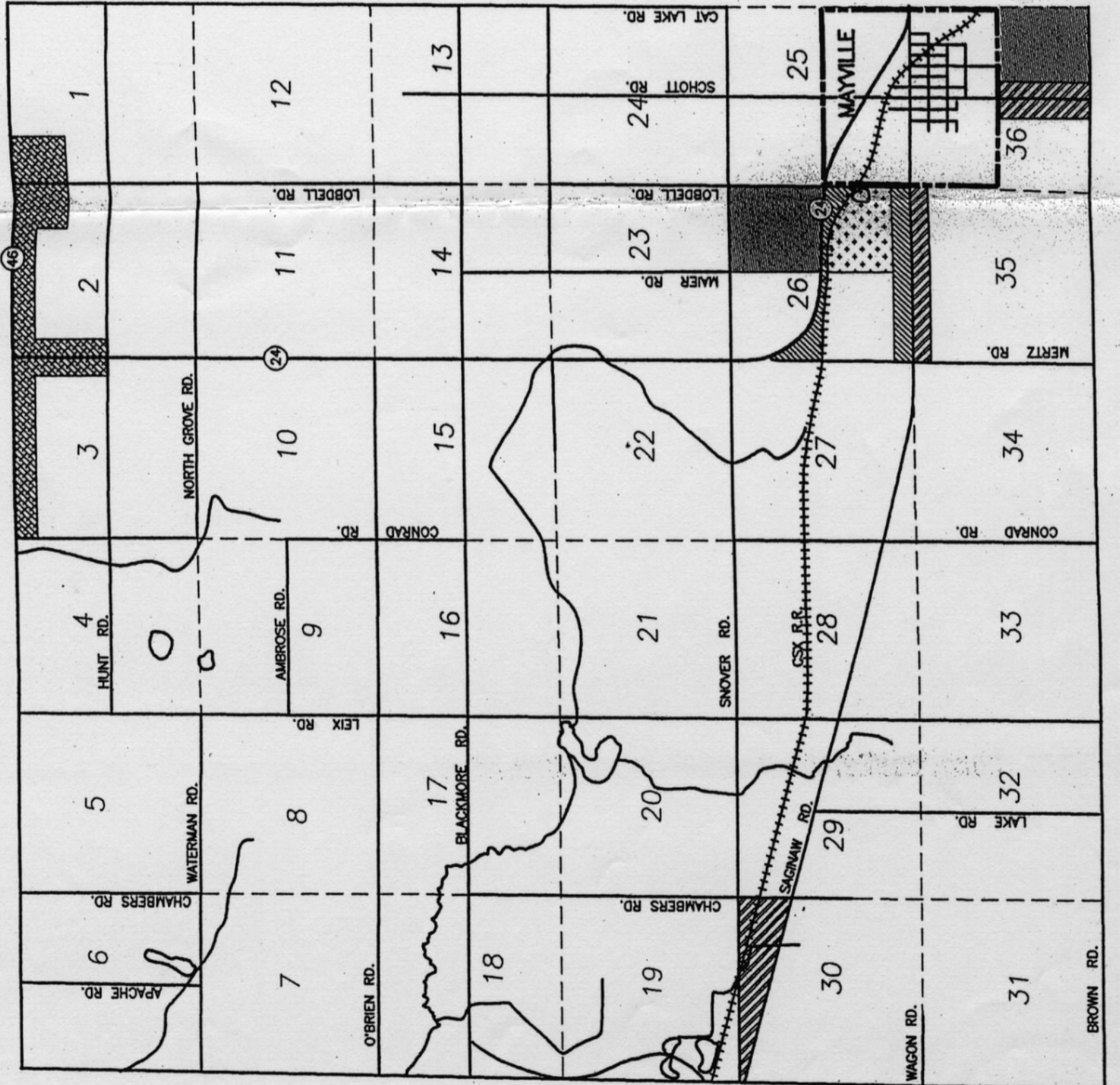

FREMONT TOWNSHIP
 T11N - R9E
 TUSCOLA COUNTY, MICHIGAN
 CLIENT: FREMONT TOWNSHIP

DATE 5-13-93
 DRN V.L.W.
 CHD



Wrook Associates, Inc.
 771 South U.S. 131
 P. O. Box 200
 Okemos, MI 48864-0200
 517 775-7700

NOTES
 F.B.
 DC

SHEET 1 of 1

SCALE

JOB NO. 92548